

**RB Rock Breaking**



# RB HYDRAULIC BREAKER





Our engineering expertise is a key differentiator, resulting in solutions that solve design challenges, meet manufacturing quality requirements and exceed performance expectations. RockBreaking's vertical integration allows us to quickly develop a custom build from your statement of work, list of requirements, or even a napkin sketch.

### CAPABILITIES WHY CHOOSE ROCKBREAKING?

Vertical Integration: By utilizing in-house designing, manufacturing and testing, we bring the highest quality and most advanced products to the market faster.

### PRODUCTS AND SOLUTIONS

We integrate our own components into our product solutions, allowing us to have 100% quality control and 100% cost control.

### MARKET FOCUS

Our research & development and financial investments are focused on continually improving the quality and performance capabilities of Rock breakers and attachments.

### ROCKBREAKING MISSION STATEMENT

To exceed customer expectations by supplying quality Rockbreaker & attachments, priced competitively, with a distribution system that is flexible, responsive and timely.

### ABOUT ROCKBREAKING QUALITY POLICY

At RockBreaking we are committed to providing Rock breakers as well attachments to the worldwide marketplace. All employees are responsible to continuously improve the business system in order to provide an innovative working environment that is responsive to our customers' needs and meets their requirements



## **JUST ALL-IN-ONE MANUFACTURING SYSTEM/RB BREAKERS**

In Raw materials

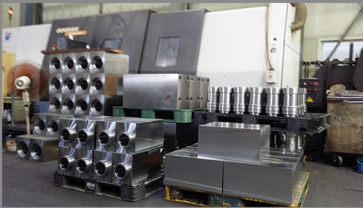

CNC Process



Milling



Grinding



Hole & Special treatments



Accumulator Process



Finished Components



Breaker Final Test



Wooden packing



Ready for breakers  
loading ro container



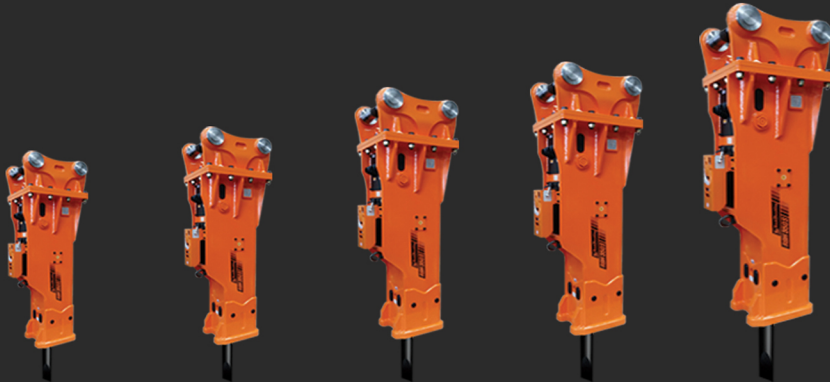

### SILENCED HEAVY DUTY HOUSING TYPE (S VERSION)

RB says its new RBH-S series adopts hydraulic breakers with nitrogen-assisted operating. It is designed to prevent any damage caused by operating vibration which could otherwise be detrimental to both carrier and breaker itself.

### SPECIAL FEATURES

- Box typed heavy duty housing
- Internal polyurethane buffers reduces noise and absorbs vibration
- MC nylon plates are designed for fit tight on surrounded for sides
- Hardox steel on bottom side is designed to reduce abrasion
- Stable operating performance
- Easy Interoperability of breaker components
- Easy adjustment of impact rate
- New Upgraded Auto Lubrication system

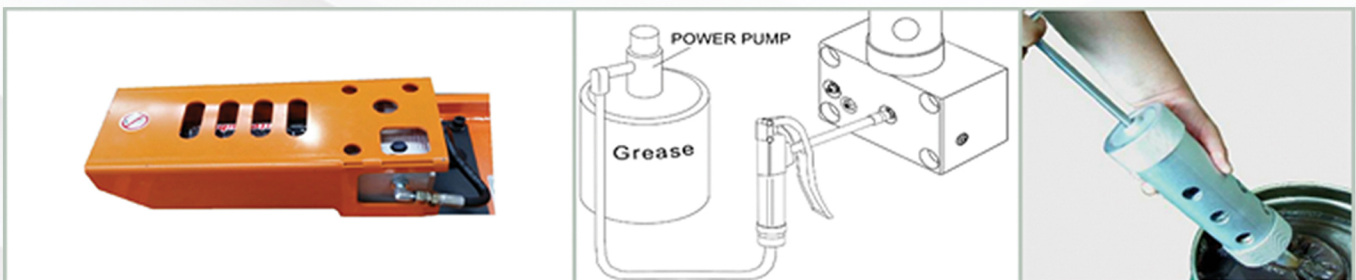
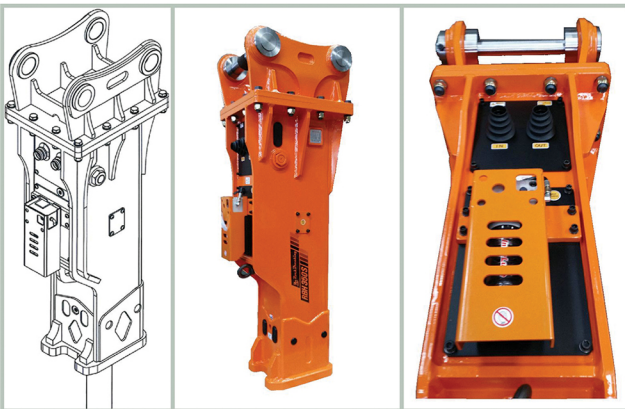

### PATENTED ADJUSTABLE VIBRATION & NOISE BUFFER SYSTEM

RB breakers have a patented buffer plate system. It provides the most minimal vibration transferring back through to the carrier machine.

The buffer plate system can be inspected and adjusted externally. This provides maximum life to the internal components of the breaker.





### SPECIFICATIONS: SMALL SIZED RANGE

MODEL	UNIT	RBH20S	RBH30S	RBH35S	RBH40S	RBH50S	RBH70S	RBH100S
IMPACT ENERGY CLASS	FT/LBS	117	231	347	470	542	999	1158
	JOULE	159	314	470	637	735	1354	1570
FREQUENCY RANGE	BPM	700 - 1200	600 - 1100	500 - 1000	500 - 900	400 - 800	400 - 800	350 - 700
WEIGHT(WITH CHISEL TOOL)	LBS	220	265	493	657	827	1272	1962
	KG	100	120	224	298	375	577	890
BACK HEAD N2 GAS PRESSURE	PSI	174	174	174	174	232	232	232
	BAR	12	12	12	12	16	16	16
PIPING INNER DIAMETER	INCH	1/2"	1/2"	1/2"	1/2"	1/2"	3/4"	3/4"
	MM	12.7	12.7	12.7	12.7	12.7	19.05	19.05
CHISEL TOOL DIAMETER	INCH	1.77	2.1	2.36	2.7	3	3.4	3.9
	MM	45	53	60	68	75	85	100
HYDRAULIC PRESSURE (OPERATING PRESSURE)	PSI	1305 - 1740	1305 - 1740	1450 - 1885	1595 - 2031	1740 - 2176	1855 - 2321	2176 - 2465
	BAR	90 - 120	90 - 120	100 - 130	110 - 140	120 - 150	130 - 160	150 - 170
FLOW RANGE (CARRIER OUTPUT)	GPM	5.3 ~ 10.6	6.6 ~ 13.2	7.9 ~ 15.9	10.6 ~ 18.5	13.2 ~ 23.8	15.9 ~ 26.4	21.1 ~ 29.1
	LPM	20 ~ 40	25 ~ 50	30 ~ 60	40 ~ 70	50 ~ 90	60 ~ 100	80 ~ 110
CIRCUIT RELIEF VALVE SETTING (REFER TO ATTACHED DIAGRAM)	PSI	2031	2175	2175	2321	2611	2611	2756
	BAR	140	150	150	160	180	180	190
SOUND POWER LEVEL (LPA/LWA)	dBa	86/114	86/114	87/116	88/116	87/115	88/116	89/117
CARRIER MACHINE WEIGHT RANGE	TONS	1.2 ~ 3.0	2.5 ~ 4.5	3.0 ~ 5.5	4.0 ~ 7.0	6.0 ~ 9.0	7.0 ~ 14	11 ~ 16

### SPECIFICATIONS: MID-LARGE SIZED RANGE

MODEL	UNIT	RBH150S	RBH220S	RBH250S	RBH350S	RBH450S
IMPACT ENERGY CLASS	FT/LBS	2176	3142	3433	4853	6654
	JOULE	2951	4260	4655	6580	9022
FREQUENCY RANGE	BPM	450 - 700	450-600	350-500	300-450	300-400
WEIGHT(WITH CHISEL TOOL)	LBS	2668	3748	3937	4630	7297
	KG	1210	1700	1786	2100	3310
BACK HEAD N2 GAS PRESSURE	PSI	87	87	232	87	232
	BAR	6	6	16	6	16
ACCUMULATOR N2 GAS	PSI	870	870	870	870	870
	BAR	60	60	60	60	60
PIPING INNER DIAMETER	INCH	1"	1"	1"	1"	1-1/4"
	MM	25.4	25.4	25.4	25.4	31.75
CHISEL TOOL DIAMETER	INCH	4.7	5.3	5.5	5.9	6.3(6.1)
	MM	120	135	140	150	160(155)
HYDRAULIC PRESSURE (OPERATING PRESSURE)	PSI	2175-2465	2320-2610	2320-2610	2320-2610	2465-2755
	BAR	150-170	160-180	160-180	160-180	170-190
FLOW RANGE (CARRIER OUTPUT)	GPM	24-32	26-39	32-48	42-50	50-66
	LPM	90-121	100-150	121-180	160-190	190-250
CIRCUIT RELIEF VALVE SETTING (REFER TO ATTACHED DIAGRAM)	PSI	3046	3046	3336	3336	3481
	BAR	210	210	230	203	240
SOUND POWER LEVEL (LPA/LWA)	dBa	90/118	91/119	93/121	93/121	94/121
CARRIER MACHINE WEIGHT RANGE	TONS	15~21	18~26	18~28	27~35	32~48

### OPEN HEAVY DUTY HOUSING TYPE (T VERSION)

RB says its new RBH-T series adopts hydraulic breakers with nitrogen-assisted operating method. It is designed to operate under the extreme hottest place, such as the middle-east or no restriction of noise regulation place. The most advantage it is easily replaced the breaker components.

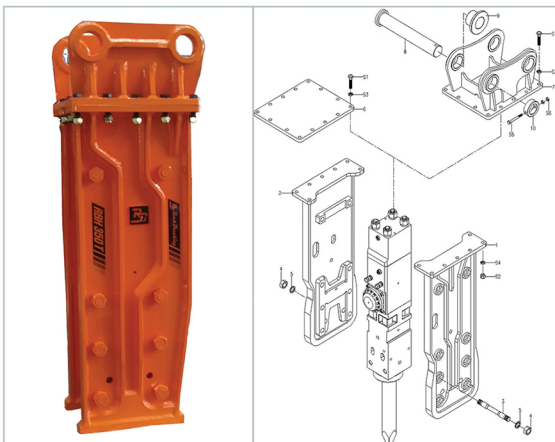

### SPECIAL FEATURES

- Dual side plate tighten with reinforced eights pins
- Hardox steel on bottom side is designed to reduce abrasion
- Easy maintenance for the components replacement
- Hardox steel on bottom side is designed to reduce abrasion
- Stable operating performance
- Easy Interoperability of breaker components
- Easy adjustment of impact rate
- New Upgraded Auto Lubrication system



### SPECIFICATIONS: SMALL SIZED RANGE

MODEL	UNIT	RBH20T	RBH30T	RBH35T	RBH40T	RBH50T	RBH70T	RBH100T
IMPACT ENERGY CLASS	FT/LBS	117	231	347	470	542	999	1158
	JOULE	159	314	470	637	735	1354	1570
FREQUENCY RANGE	BPM	700 - 1200	600 - 1100	500 - 1000	500 - 900	400 - 800	400 - 800	350 - 700
WEIGHT(WITH CHISEL TOOL)	LBS	220	265	493	657	827	1272	1962
WITH TOP BRACKET	KG	100	120	224	298	375	577	890
BACK HEAD N2 GAS PRESSURE	PSI	174	174	174	174	232	232	232
	BAR	12	12	12	12	16	16	16
PIPING INNER DIAMETER	INCH	1/2"	1/2"	1/2"	1/2"	1/2"	3/4"	3/4"
	MM	12.7	12.7	12.7	12.7	12.7	19.05	19.05
CHISEL TOOL DIAMETER	INCH	1.77	2.1	2.36	2.7	3	3.4	3.9
	MM	45	53	60	68	75	85	100
HYDRAULIC PRESSURE (OPERATING PRESSURE)	PSI	1305 - 1740	1305 - 1740	1450 - 1885	1595 - 2031	1740 - 2176	1855 - 2321	2176 - 2465
	BAR	90 - 120	90 - 120	100 - 130	110 - 140	120 - 150	160 - 160	150 - 170
FLOW RANGE (CARRIER OUTPUT)	GPM	5.3 ~ 10.6	6.6 ~ 13.2	7.9 ~ 15.9	10.6 ~ 18.5	13.2 ~ 23.8	15.9 ~ 26.4	21.1 ~ 29.1
	LPM	20 ~ 40	25 ~ 50	30 ~ 60	40 ~ 70	50 ~ 90	60 ~ 100	80 ~ 110
CIRCUIT RELIEF VALVE SETTING (REFER TO ATTACHED DIAGRAM)	PSI	2031	2175	2175	2321	2611	2611	2756
	BAR	140	150	150	160	180	180	190
CARRIER MACHINE WEIGHT RANGE	TONS	1.2 ~ 3.0	2.5 ~ 4.5	3.0 ~ 5.5	4.0 ~ 7.0	6.0 ~ 9.0	7.0 ~ 14	11 ~ 16

### SPECIFICATIONS: MID-LARGE SIZED RANGE

MODEL	UNIT	RBH150T	RBH220T	RBH250T	RBH350T	RBH450T	RBH550T
IMPACT ENERGY CLASS	FT/LBS	2176	3142	3433	4853	6654	10997
	JOULE	2951	4260	4655	6580	9022	14910
FREQUENCY RANGE	BPM	450-800	450-600	350-500	300-450	300-400	200-350
WEIGHT(WITH CHISEL TOOL)	LBS	2733	3813	4003	4739	7451	8983
WITH TOP BRACKET	KG	1240	1730	1816	2150	3380	4075
BACK HEAD N2 GAS PRESSURE	PSI	87	87	232	130	145	239
	BAR	6	6	16	9	10	16.5
ACCUMULATOR N2 GAS	PSI	788	788	788	870	870	870
	BAR	55	55	55	60	60	60
PIPING INNER DIAMETER	INCH	1"	1"	1"	1"	1-1/4"	1-1/4"
	MM	25.4	25.4	25.4	25.4	31.75	31.75
CHISEL TOOL DIAMETER	INCH	4.7	5.3	5.5	5.9	6.3(6.1)	6.9(7.3)
	MM	120	135	140	150	160(155)	175(185)
HYDRAULIC PRESSURE (OPERATING PRESSURE)	PSI	2175-2465	2320-2610	2320-2610	2320-2610	2320-2610	2320-2610
	BAR	150-170	160-180	160-180	160-180	160-180	160-180
FLOW RANGE (CARRIER OUTPUT)	GPM	24-32	26-39	32-48	42-50	50-66	55.5-76.6
	LPM	90-120	100-150	120-180	160-190	190-250	210-290
CIRCUIT RELIEF VALVE SETTING (REFER TO ATTACHED DIAGRAM)	PSI	3046	3046	3336	3336	3481	3625
	BAR	210	210	230	230	240	250
CARRIER MACHINE WEIGHT RANGE	TONS	15~21	18~26	18~28	27~35	32~48	42~58

### RB FULLY HYDRAULIC BREAKERS

The production of RB fully hydraulic series is based on many years of experience and the use of heavy duty housing, which enables the equipment to resist the mechanical and thermic stress occurring under normal working conditions.

### SPECIAL FEATURES

- Acceptable for large range of flow
- Easy operation for not only operator but also carrier
- Decreasing maintenance cost with increasing life time by reducing friction of consumable parts
- Low recoil system for carrier operator's agreeable condition
- Option: Auto Lubricant system

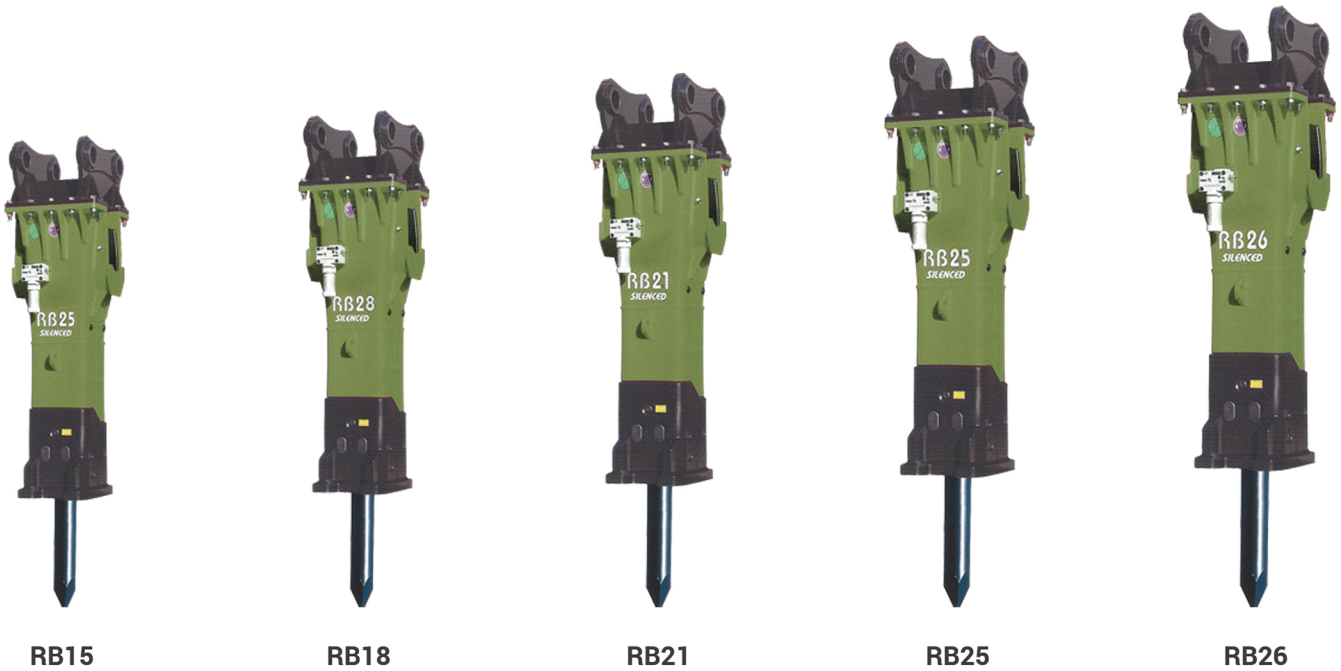

### STANDARD SPECIFICATION

DESCRIPTION	UNIT	RB15	RB18	RB21	RB25	RB26
Operating Weight (Tool + M/T Cap)	kg	1,123	1,500	1,874	1,910	1,920
	lbs	2,476	3,307	4,131	4,211	4,233
Tool Diameter	mm / inch	115 / 4.53	120 / 4.72	130 / 5.12	130 / 5.12	135 / 5.31
Applicable Excavator	ton	13 ~ 20	18 ~ 25	18 ~ 30	18 ~ 30	18 ~ 30
	lbs	29,708 ~ 44,562	39,681 ~ 55,113	39,683 ~ 66,139	39,683 ~ 66,139	39,683 ~ 66,139
Impact Rate	bpm	350 ~ 550	400 ~ 500	350 ~ 500	350 ~ 500	350 ~ 500
Operating Pressure	bar	140	140	400	140	140
	psi	2,030	2,030	2,030	2,030	2,030
Setting Pressure	bar / psi	175 / 2,538	175 / 2,538	175 / 2,538	175 / 2,538	175 / 2,538
Back Head Pressure	bar / psi	5 / 73	5 / 73	5 / 73	5 / 73	5 / 73
Accumulator Pressure	bar / psi	40 / 580	40 / 580	40 / 580	40 / 580	40 / 580
Required Oil Flow	lpm	70 ~ 110	110 ~ 150	120 ~ 160	120 ~ 160	120 ~ 160
Noise Level	LPA	94	95	95	95	95
	LWA	122	122	123	123	123





**RB28**



**RB38**



**RB48**



**RB68**

**STANDARD SPECIFICATION**

DESCRIPTION	UNIT	RB28	RB38	RB48	RB68
Operating Weight (Tool + M/T Cap)	kg	2,396	3,006	3,920	4,682
	lbs	5,282	6,627	8,642	10,321
Tool Diameter	mm / inch	140 / 5.51	155 / 6.10	170 / 6.69	180 / 7.09
Applicable Excavator	ton	26 ~ 38	33 ~ 48	43 ~ 63	52 ~ 75
	lbs	58,102 ~ 84,512	72,894 ~ 106,028	95,058 ~ 138,266	113,536 ~ 165,144
Impact Rate	bpm	360 ~ 520	320 ~ 420	300 ~ 400	250 ~ 350
Operating Pressure	bar	140	145	155	155
	psi	2,030	2,103	2,248	2,248
Setting Pressure	bar / psi	175 / 2,538	185 / 2,683	190 / 2,756	190 / 2,756
Back Head Pressure	bar / psi	5 / 73	5 / 73	5 / 73	5 / 73
Accumulator Pressure	bar / psi	40 / 580	40 / 580	40 / 580	40 / 580
Required Oil Flow	lpm	160 ~ 230	170 ~ 240	190 ~ 250	220 ~ 350
Noise Level	LPA	96	97	98	99
	LWA	124	125	126	127

**RB FULLY HYDRAULIC BREAKER CROSS-SECTION DIAGRAM**

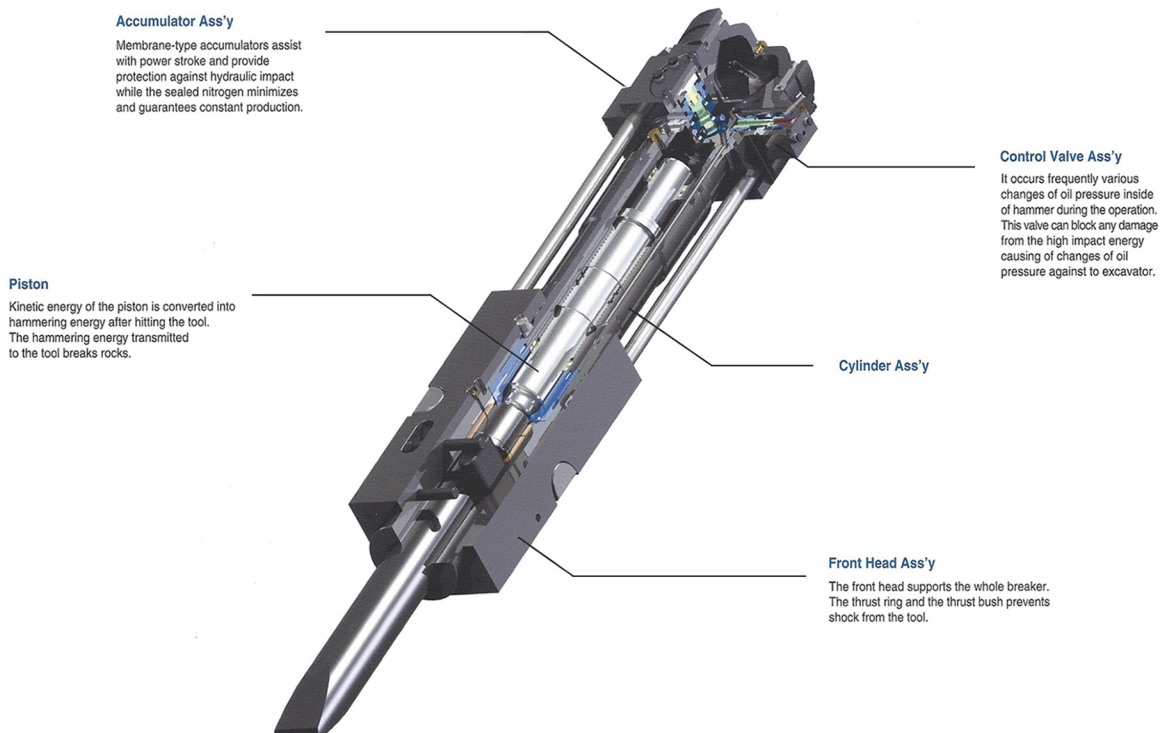



### SKID-STEER LOADERS TYPE

Brand new RB Hydraulic Breaker for every brands of Skid-Steer Loaders, come with mounting Bracker for loader fit ASV, Bobcats, Cat, Case, Gehl, Komatsu, Mustang, Volvo, Thomas, Takeuchi, etc.

## Special Features

- High impact energy & Low noise level
- High performance ability
- Low maintenance cost
- Universal Mounting frame



RBH20SL

RBH30SL

### Standard Specification

DESCRIPTION	UNIT	RBH8SL	RBH10SL	RBH20SL	RBH30SL
Operating Weight	kg / lbs	190 / 419	280 / 617	382 / 842	475 / 1,047
Tool Diameter	mm / inch	45 / 1.77	53 / 2.09	68 / 2.68	75 / 2.95
Impact Rate	bpm	700 ~ 1,200	550 ~ 1,000	500 ~ 950	450 ~ 1,000
Operating Pressure	bar / psi	80 ~ 100 / 1,160 ~ 1,450	90 ~ 120 / 1,305 ~ 1,740	95 ~ 130 / 1,378 ~ 1,885	100 ~ 130 / 1,450 ~ 1,885
Setting Pressure	bar / psi	130 / 1,885	150 / 2,175	160 / 2,320	160 / 2,320
Back Head Pressure	bar / psi	12 / 174	16 / 232	16 / 232	16 / 232
Required Oil Flow	lpm	15 ~ 25	25 ~ 40	30 ~ 60	40 ~ 90
Noise Level	LPA	85	86	87	88
Valve Ass'y Position		Internal	Internal	Internal	Internal

- Above specifications are subject to change without prior notice for improvement in quality





## BACKHOE LOADERS TYPE

All Backhoe Loaders type breaker utilize a streamlined and lightweight design that sets a new standard in low weight and high power.

## Special Features

- High performance ability with anti-wear resistance
- High efficient work by optimized control valve



RBH20BL

RBH30BL

## Standard Specification

DESCRIPTION	UNIT	RBH20BL	RBH30BL
Operating Weight	kg / lbs	326 / 719	410 / 904
Tool Diameter	mm / inch	68 / 2.68	75 / 2.95
Impact Rate	bpm	500 ~ 950	450 ~ 1,000
Operating Pressure	bar / psi	95 ~ 130	100 ~ 130
Setting Pressure	bar / psi	160 / 2,320	160 / 2,320
Back Head Pressure	bar / psi	16 / 232	16 / 232
Required Oil Flow	lpm	30 ~ 60	40 ~ 90
Valva Ass'y Position		Internal	Internal

- Above specifications are subject to change without prior notice for improvement in quality

## STEEL CHARACTERISTICS

Hydraulic breaker that crushes rocks continuously with excellent impact toughness, wear resistance and fatigue  
Excellent carburizing and Q/T heat treatment characteristics

## APPLIED PARTS

Chisel: the part that directly crushes rocks

**Standard tool steel grade. SCM440**, these tool is best suited for use in application where the material allows a low or medium rate of penetration. Warranty. six months



**Hard rock tool steel grade. AE4140Mod.**, reinforced steel AE4140 allowed them to penetrate very hard rock without iron dust (occurred from tool). Please see the below a photo of defective piston that occurred some iron dust from tool. Warranty. six months

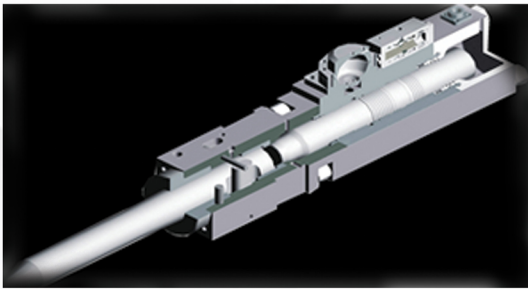

**Piston** : reciprocating force that hits chisel so that chisel can crush rocks steel grade. SNCM26V, warranty. Twelve months

**Cylinder** : the center of breaker where hydraulic circuit is located to reciprocate piston steel grade. SCM415C2, warranty. twelve months

**Through bolt** : To fix front head, cylinder and back head of breaker body



AVAILABLE MANUFACTURING COMPONENTS BRANDS

- FURUKAWA, NPK, ATLAS COPCO, BTI, SANDVIK, MONTABERT, SOOSAN



## TECHNOLOGY DEVELOPMENT

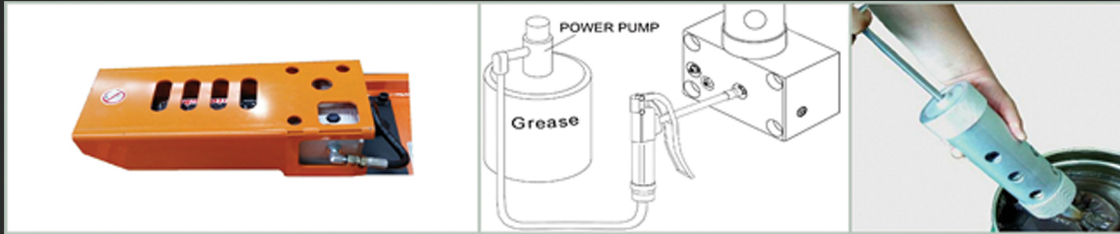

**Upgrade Auto lubrication system** designed to ensure a long, trouble-free life specially for hydraulic breakers. Cartridge can be easily refilled via grease gun greatly reducing costs compare to other auto grease system. RB engineer developed new steel cover auto lube system as the attached photos, which has more convenient grease input function.

**Adjustable Impact**, the dual speed control lets you adjust the breaker impact levels to suit your application, whether you need high power with low frequency, or high frequency with reduced power.

**Service tool box and N2 gas bottle**, RB breaker is supplied with its own service tool box which is essential to operate and maintain RB breaker effectively. The tool box contains N2 gas charging kit set, seal kit, and wrench, etc..



### Mini Hyd.Crusher



#### Feature

- Lightweight design for stability of operating machine
- One cylinder system for powerful crushing and speed
- High strength and wear resistance materials for reliability
- Full line-up for mini excavators

	UNIT	EXMC50H
Pressure (Rotation)	bar	120
	psi	1740
Oil flow (Cylinder)	LPM	40-80
	GPM	10.5-21.1
Pressure (Cylinder)	bar	210
	psi	3045
Operating Weight	Kg	480
	Lbs	1058
Suitable Excavator	ton	4.5-8.0

### Mini Hyd.Shear



#### Feature

- Lightweight design for stability of operating machine
- Trunnion mounting cylinder for compact design
- High strength wear resistance materials for reliability
- Full line-up for mini excavators

	UNIT	EXMC50H
Pressure (Rotation)	bar	120
	psi	1740
Oil flow (Cylinder)	LPM	40-80
	GPM	10.5-21.1
Pressure (Cylinder)	bar	210
	psi	3045
Operating Weight	Kg	500
	Lbs	1102
Suitable Excavator	ton	4.5-8.0

### Beam Cutter/Excavator Mounted Type

#### Feature

- Adopt an excellent high strength and wear resistance materials (Hardox 400 and 600)
- Designed for the prevent of jaw gap loose
- Maximum cutting force and opening width
- Basically installed speed-up valve at ex-work
- The capability to cut H beam 450x450x20 sufficiently



Excavator Weight 2nd (Hyd.shear + Excavator Boom)



MODEL	Excavator Weight 2nd Member		Excavator Weight 3rd Member		Unit Weight	
	Lbs.	Ton	Lbs.	Ton	Lbs.	Ton
YSR-230	26500-35300	12-16	42000-57000	20-26	4300	2
YSR-340	42000-57000	20-26	59000-80000	27-36	7000	3.3
YSR-550	59000-80000	27-36	81600-100000	37-45	10300	4.7
YSR-650	81600-100000	37-45	10200-132000	46-60	15600	7.1

### Vibro Ripper



#### Feature

- Tooth changeable Vibro ripper
- Very convenient spare parts handing in Vibro ripper maintenance
- This Vibro ripper do double work both ripping and rock breaker at same time
- 2-5times powerful and speedy work more than the conventional breaker
- It could be done all works under the lowest noise in the downtown

	UNIT	EXVR 80	EXVR 100
Working pressure	Max/bar	220	220
	Max/psi	3190	3190
Oil flow	LPM	180	180
	GPM	47.55	47.55
Return pressure	Max/bar	6	6
Frequency	BPM	1400	1400
Operating Weight	Kg	2650	3400
	Lbs	5842	7495
Suitable excavator	Ton	18-25	24-36



**Excavator Mounted Pile Drivers**

**Feature**

- Lower cost of maintenance than crane hammer.
- Easier operate in critical regions such as chaotic section of city, bridge area and vicinity of high-voltage wires than crane hammer does.
- Equipped with high-powered hydraulic piston motor and suitable bearing for high frequency vibration.
- Install vibro isolating rubber for high frequency purpose.
- Pile driving power 20% up compared to the existing equipments.

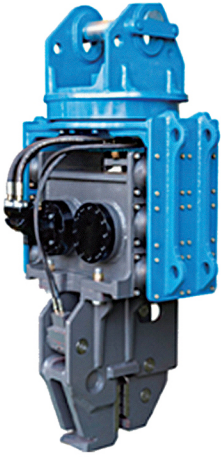

Item	UNIT	W250	W300	W400
Excavator class	ton	20-28	28-34	33-45
Operating weight	kg	1600	1800	1900
	Lbs	3527	3968	4188
Extension boom weight	kg	600	700	700
Clamping jaw	mm	65	65	65
	inch	2.56	2.56	2.56
Frequency	bpm	2000-2500	2000-2500	2000-2500
Slewing degree	degree	360	360	360
Dimension (L x W x H)	mm	1857 x 1042 x 650	1959 x 1103 x 792	2016 x 1196 x 830
Hydraulic oil flow	LPM	130-180	170-200	200-260
	GPM	34.3-47.55	44.90-52.83	52.83-68.69
Hyd. Working pressure	bar	180-200	200-250	200-250

**Multi Processor**



JAW SET OF CRUSHER  
(THE PRIMARY DEMOLITION)



JAW SET OF PULVERIZER  
(THE SECONDARY DEMOLITION)



JAW SET OF SHEAR

Item	Unit	EXMP80	EXMP100
Operating Weight	Kg	2,050	3,030
	Lbs	4,519	6,680
Jaw Opening A	mm	921	1,150
Total Width A	mm	1,398	1,600
Total Length C	mm	2,020	2,188
Total Length D	mm	2,050	2,270
Total Height E	mm	682	811
Crushing Force	ton	192	290
Speed up valve	-	Standard	
Rotating	-	360° Hyd. Rotating	
Excavator	ton	20-28	29-40

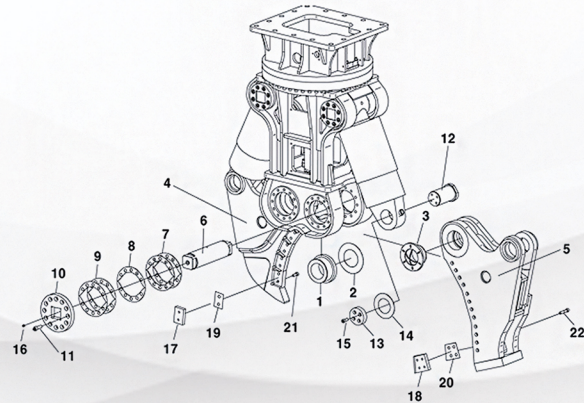

**Orange Peel Grapple**



- High-strength and abrasion resistant steel for durability
- Highly qualified hydraulic parts for reliability
- Minimize assembly clearance for accurate working
- Optimize tine shape for easy infiltratin and firm grasp
- Much comfortable space design for easy maintenance
- Various options available for customer satisfaction

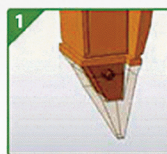

**TOOTH POINT**  
REPLACEABLE TINE TIPS

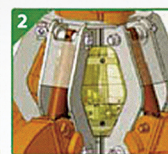

**PROTECTORS**  
ALL HYDRAULIC PARTS  
SPECIALLY PROTECTED

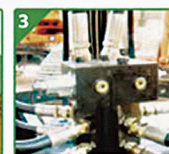

**RELIEF VALVE**  
ADJUSTABLE MAXIMUM  
CLOSING FORCE TO  
PROTECT STRUCTURE  
AND CYLINDERS



**TINE**  
HIGH STRENGTH  
ABRASION-RESISTANT  
STEEL FOR LONG LIFE



# *RB Rock Breaking*

Contact us; RockBreaking Company

Add.: Namdong Industrial Complex 45BL-2LT,  
76, Eunbong-ro 105 beon-gil, Namdong-gu, Incheon, Korea 21639

Tel. +82 (0) 70 8729 7458

Fax. +82 (0) 32 421 5282

Cell. +82 (0) 10 4717 7458

E-mail. [rockbreaking@daum.net](mailto:rockbreaking@daum.net)